

REV.	ECN. NO.	APPD.

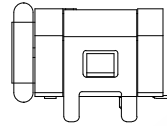
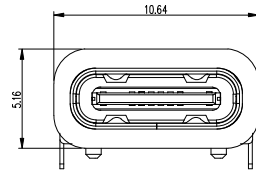
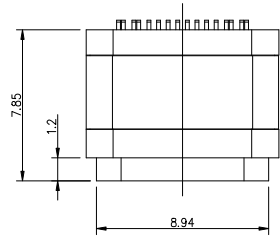

Sketch with waterproofing

USB TYPE-C PIN ASSIGNMENTS

PIN NUMBER	SIGNAL NAME	PIN NUMBER	SIGNAL NAME
A1	GND	B12	GND
A4	VBUS	B9	VBUS
A5	CC1	B8	SBU2
A6	Dp1	B7	Dn2
A7	Dn1	B6	Dp2
A8	SBU1	B5	CC2
A9	VBUS	B4	VBUS
A12	GND	B1	GND

NOTES:

SPECIFICATION:

- CURRENT RATING: 3.0A MAX
- VOLTAGE: 30 VAC
- TEMPERATURE RANGE: -30 °C ~ 85 °C
- CONTACT RESISTANCE: 40 MILLIONHM MAX
- INSULATION RESISTANCE: 100 MEGOHMS MIN.
- INSERTION FORCE : 6N~20N
- UNMATING FORCE: 8N~20N
- DURABILITY: 10,000 CYCLES

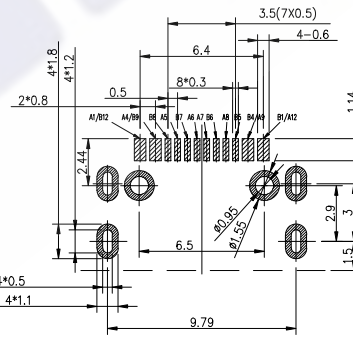
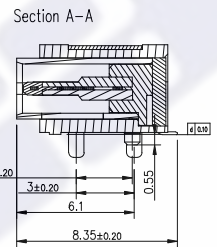
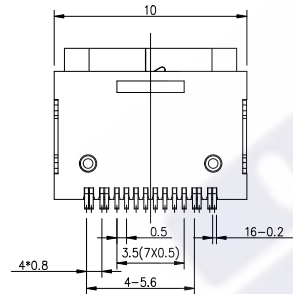
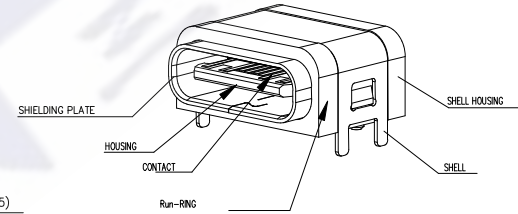
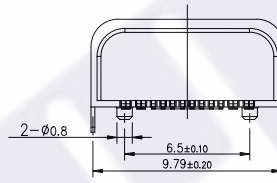
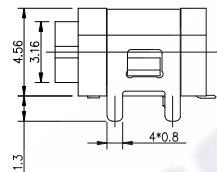
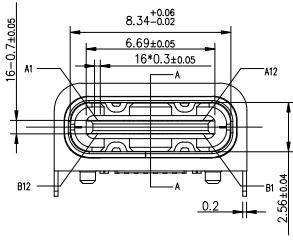

RECOMMENDED P.C.B. LAYOUT
TOLERANCE UNSPECIFIED ±0.05mm

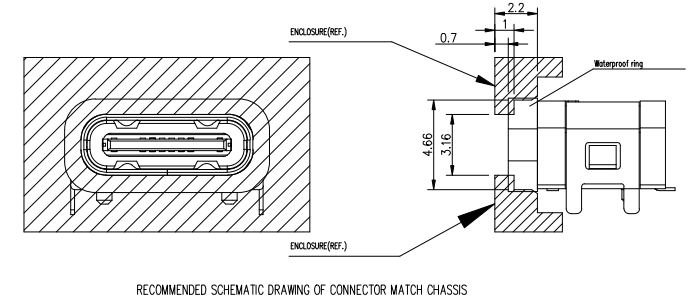

RECOMMENDED SCHEMATIC DRAWING OF CONNECTOR MATCH CHASSIS

NO	DESCRIPTION	QTY	MATERIAL	REMARKS
6	Run-RING	1PCS	Silica gel	BLACK
5	SHELL	1PCS	STAINLESS STEEL	Ni Plated:40µMIN
4	SHIELDING PLATE	1PCS	STAINLESS STEEL	Ni Plated:40µMIN
3	CONTACT	1SET	Brass	Contact Plating: Au (1u") Soldering Plating: Au 1u"
2	SHELL HOUSING	1PCS	LCP	BLACK
1	HOUSING	1PCS	LCP	BLACK

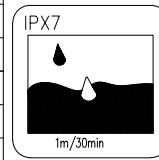

The copyright belongs to samzo parts [China] Co., Ltd. please use the material after samzo parts agree to authorize. The final right of interpretation belongs to samzo parts.

X.	± 0.50	X.'	± 2'
.X	± 0.30	.X'	± 1'
.XX	± 0.20	.XX'	± 0.5'
.XXX	± 0.05		

UNITS	mm
MAT'L	—
FINISH	—
Q'TY	—

PART NO.	MTKEF16WD1FDWNG1N
APPD:	RADOM
CHKD:	MARK
DR:	JANE CHOU 2020/09/26

三佐部品【中国】股份有限公司

TITLE:
TYPE C 2.0 16Pin SMT Type

DWG NO.:
MTKEF16WD1FDWNG1N

SCALE	SHEET	REV.
1/1	1/2	A2